

Highlights

- *Constant Force (CF) proprietary motion technology provides premium tilt adjustment—set display in position with just your fingertips*
- *Single SKU universal design fits most 32–61" flat panels up to 175 lbs (79 kg)*
- *Easily connect and detach display*
- *Integrated security fasteners deter removal*
- *Includes fasteners for mounting to wood studs or concrete wall surfaces*
- *5 year warranty*



Ergotron® TM

Large Display Tilting Wall Mount



More motion. Less effort. Feel the difference.

Enhance any viewing experience. Ergotron's Large Display Tilting Wall Mount is the perfect accessory for large plasma displays or LCD TVs up to 175 lbs. Attaching your valuable (and heavy) flat panel investment to a wall can be nerve-racking. So we took our engineering know-how and created an extremely stable wall mount solution. Then we made it better. We've added our proprietary CF™ motion technology.

Now anyone at the office or at home (even children) can effortlessly adjust the tilt of a screen. And once assembled, Ergotron's unique security fasteners deter others from removing your display.

- Tilt your screen with just your fingertips; no knobs or levers
- Sleek, silver and charcoal grey design complements home or office decor
- Protect your investment: integrated security fasteners hold the large display or TV in place
- View in comfort: cut glare and improve sight lines for optimal viewing
- Buy smart: approximately half the price of competing models!
- Single-SKU design fits most flat panel screens from 32 to 61 inches



Easy installation: attach two mounting brackets to back of the large display or TV and latch onto wall plate. Fits most 32–61" displays weighing up to 175 lbs (79 kg).



No knobs or levers are used to activate the tilt motion or hold the position of display!

Constant Force (CF) proprietary motion technology provides premium tilt adjustment.



Security fasteners on mounting brackets prevent easy removal of the display.

Range of Motion

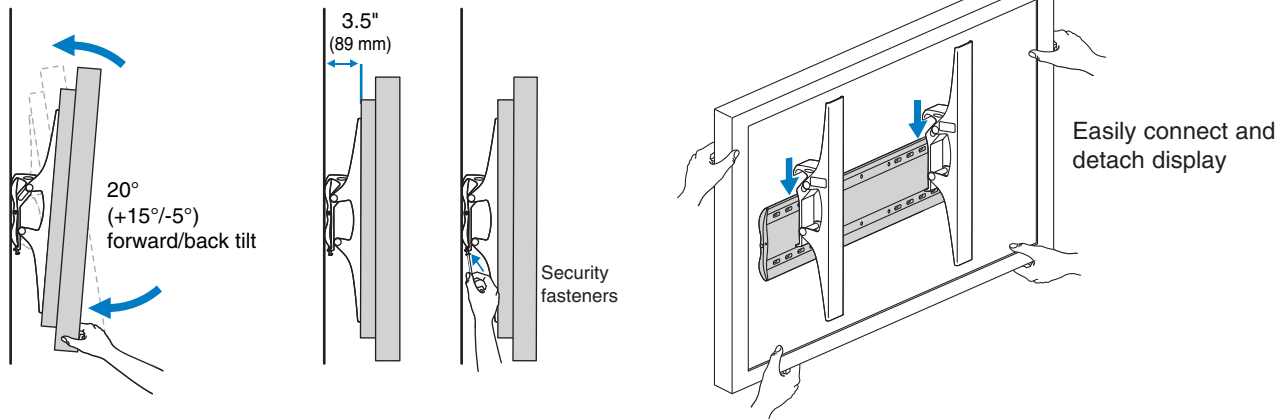

Basic Specifications

Description and Model:

Large Display Tilting Wall Mount, model TM00VH1S
 Consumer Part Number: 60-573-003 (silver)
 Commercial Part Number: 60-572-003 (silver)

Attachment Options:

Wall plate attaches to vertical wall surfaces. Includes fasteners for wood (16" or 24" centered studs) or concrete wall mounting. For mounting to metal studs or other surfaces, customer must supply fasteners.

Weight Capacity: 175 lbs (79 kg)

Shipping Weight: 16 lbs (7.5 kg)

Product size (mounted): 33.35" W x 18.54" H x 3.50" D
 (847 x 471 x 89 mm)

Display Interface Options:

Mounts to most large displays based on the mounting hole spacing range below:

- Horizontal—100 mm (min.) to 750 mm (max.)
- Vertical—100 mm (min.) to 450 mm (max.)

Warranty: 5 years

© 2005 Ergotron, Inc.
 rev. 08/03/2005 870-05-058

Content is subject to change without notification.

Ergotron, Inc.: St. Paul, MN; (800) 888-8458;
 www.ergotron.com; sales@ergotron.com

Ergotron Europe: Amsterdam, The Netherlands;
 Tel. +31 20 312.29.39; info.eu@ergotron.com

Ergotron Canada: Toronto, Ontario;
 (800) 267-9912; info.ca@ergotron.com

